

编带方法的细节说明

■ 贴片型 编带尺寸

Fig.1

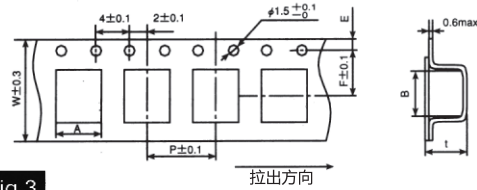

Fig.2

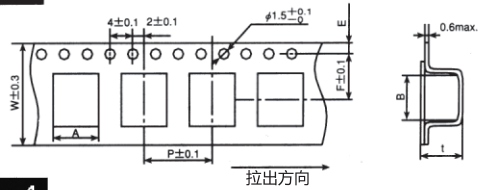

Fig.3

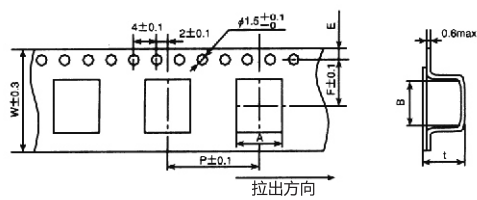
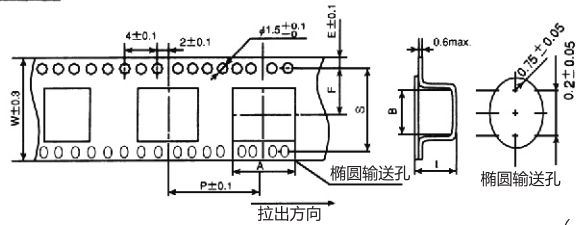
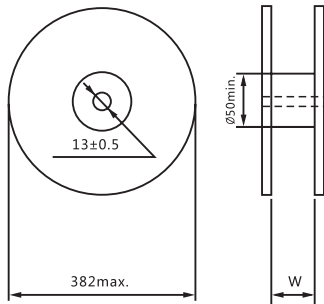

Fig.4



系列	尺寸代码	Fig	W	A	B	F	E	P	t	S
AL CHIP reALcap™	∅ 3 (B55)	1	12	3.5±0.2	3.5±0.2	5.5	1.75±0.1	8	5.9±0.2	-
	∅ 4 (D55, D56, D61)	1	12	4.7±0.2	4.7±0.2	5.5	1.75±0.1	8	5.7±0.2 (D55, D56) 6.3±0.2 (D61)	-
	∅ 5 (E55, E56, E61)	2	12	5.7±0.2	5.7±0.2	5.5	1.75±0.1	12	5.7±0.2 (E55, E56) 6.3±0.2 (E61)	-
	∅ 6.3 (F55, F56, F60, F61)	2	16	7.0±0.2	7.0±0.2	7.5	1.75±0.1	12	5.7±0.2 (F55, F56) 6.3±0.3 (F60, F61)	-
	∅ 6.3 × 8L (F80)	2	16	7.0±0.2	7.0±0.2	7.5	1.75±0.1	12	8.2±0.2	-
	∅ 8 × 6L (H63)	2	16	8.7±0.2	8.7±0.2	7.5	1.75±0.1	12	6.8±0.2	-
	∅ 8 × 6.7L (H70)	2	24	8.7±0.2	8.7±0.2	11.5	1.75±0.1	12	7.3±0.2	-
	∅ 8 × 10L (H10)	3	24	8.7±0.2	8.7±0.2	11.5	1.75±0.1	16	11.0±0.2	-
	∅ 8 × 11.5L (H12)	3	24	8.7±0.2	8.7±0.2	11.5	1.75±0.1	16	12.3±0.2	-
	∅ 10 × 8.5L (J85)	3	24	10.7±0.2	10.7±0.2	11.5	1.75±0.1	16	9.1±0.2	-
	∅ 10 × 10L (J10)	3	24	10.7±0.2	10.7±0.2	11.5	1.75±0.1	16	11.0±0.2	-
	∅ 10 × 12.2L (J12)	3	24	10.7±0.2	10.7±0.2	11.5	1.75±0.1	16	13.0±0.2	-
∅ 12.5 × 13.5L (K14)	4	32	13.4±0.2	13.4±0.2	14.2	1.75±0.1	24	14.0±0.2	28.4±0.1	

卷盘 (REEL)



每个卷盘数量

系列	尺寸代码	W(mm)	数量(个/卷盘)	数量(个/箱)
AL CHIP reALcap™	∅ 3 (B55)	14	2,000	20,000
	∅ 4 (D55, D56, D61)	14	2,000	20,000
	∅ 5 (E55, E56, E61)	14	1,000	10,000
	∅ 6.3 (F55, F56, F60, F61)	18	1,000	10,000
	∅ 6.3 × 8L (F80)	18	900	9,000
	∅ 8 × 6L (H63)	18	1,000	10,000
	∅ 8 × 6.7L (H70)	26	1,000	6,000
	∅ 8 × 10L (H10)	26	500	3,000
	∅ 8 × 11.5L (H12)	26	400	2,400
	∅ 10 × 8.5L (J85)	26	500	3,000
	∅ 10 × 10L (J10)	26	500	3,000
	∅ 10 × 12.2L (J12)	26	400	2,400
∅ 12.5 × 13.5L (K14)	34	200	1,000	

极性方向

- AL CHIP
- reALcap™

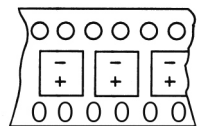
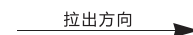
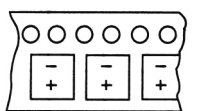
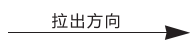

■ 贴片型 (托盘)

尺寸 (mm)

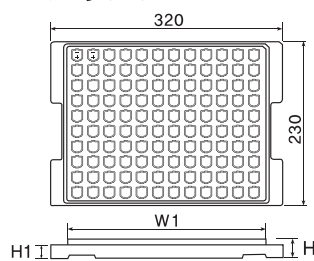

每 托盘/箱 数量

尺寸代码	H (mm)	W1 (mm)	H1 (mm)	数量(个/托盘)	数量(个/箱)
L17~L22	28.0	284	24.0	80	160,400
M17~M22	28.0	284	24.0	60	120,300

■ 小型品

单位(mm)

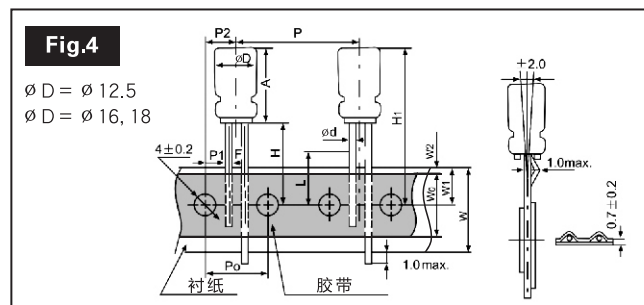
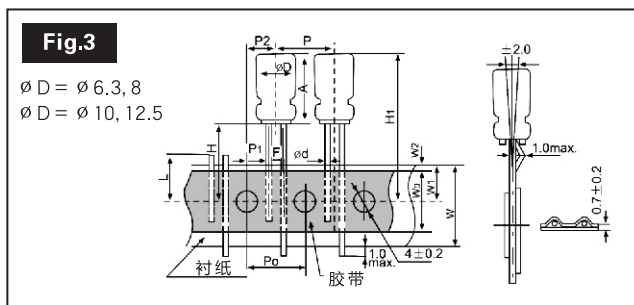
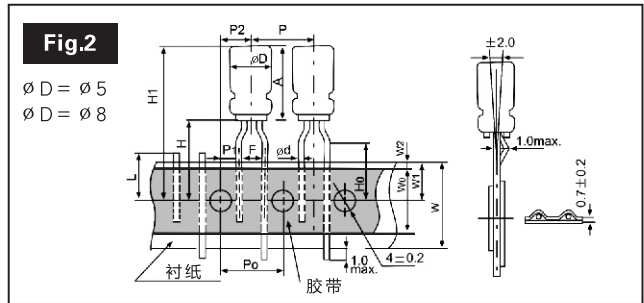
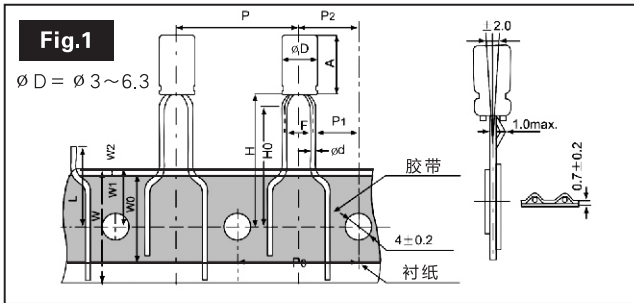

记号	尺寸		ϕd	P	P0	P1	P2	F	W	W0	W1	W2	H	H0	H1	L	Fig.	
	ϕD	A																
许公差	± 0.5	※1)	± 0.05	± 1.0	± 0.2	± 0.7	± 1.0	$+0.8$ -0.2	± 0.5	min.	± 0.5	max.	± 0.75	± 0.5	-	max.		
公称值	4	5~7	0.45	12.7	12.7	$\frac{5.1}{3.85}$	6.35	$\frac{2.5}{5.0}$	18.0	10	9.0	1.5	$\frac{18.2}{17.5}$	- 16.0	检查插入机器的规格 H1 = H + A	11.0	1 2	
		5	5~7	0.45	12.7	12.7	$\frac{5.1}{3.85}$	6.35	$\frac{2.5}{5.0}$	18.0	10	9.0	1.5	$\frac{18.2}{17.5}$		- 16.0	11.0	1 2
	6.3		11~15	0.5	12.7	12.7	$\frac{5.1}{3.85}$	6.35	$\frac{2.5}{5.0}$	18.0	10	9.0	1.5	18.5		$\frac{17.2}{16.0}$	11.0	2 2
		8	5~7	0.45	12.7	12.7	$\frac{5.1}{3.85}$	6.35	$\frac{2.5}{5.0}$	18.0	10	9.0	1.5	$\frac{18.2}{17.5}$		- 16.0	11.0	3 2
	8		※2) 5	0.45	12.7	12.7	$\frac{5.1}{3.85}$	6.35	$\frac{2.5}{5.0}$	18.0	10	9.0	1.5	18.2 17.5		- 16.0	11.0	3 2
		8	7	0.45	12.7	12.7	$\frac{5.1}{3.85}$	6.35	$\frac{3.5}{5.0}$	18.0	10	9.0	1.5	20 18.5		- 16.0	11.0	3 2
	8		9	0.6	12.7	12.7	$\frac{5.1}{3.85}$	6.35	$\frac{3.5}{5.0}$	18.0	10	9.0	1.5	20		- 16.0	11.0	3 2
		8	11~20	0.6	12.7	12.7	$\frac{4.6}{3.85}$	6.35	$\frac{3.5}{5.0}$	18.0	10	9.0	1.5	18.5		- 15.7	11.0	3 2
	许公差		± 0.5	max.	± 0.05	± 1.0	± 0.3	± 0.7	± 1.3	$+0.8$ -0.2	± 0.5	min.	± 0.5	max.		± 0.75	-	max.
	公称值	10	27	0.6	12.7	12.7	3.85	6.35	5.0	18.0	12.5	9.0	1.5	18.5		-	11.0	3
		12.5	27	0.6	15	15	5.0	7.5	5.0	18.0	12.5	9.0	1.5	18.5		-	11.0	3
				● 0.6	25.4	12.7	3.85	6.35	5.0	18.0	12.5	9.0	1.5	18.5		-	11.0	4
16		37.5	0.8	30	15	3.75	7.5	7.5	18.0	12.5	9.0	3.0	18~20	-	11.0	4		
18	37.5	0.8	30	15	3.75	7.5	7.5	18.0	12.5	9.0	3.0	18~20	-	11.0	4			

● P=25.4的编带不是标准值,请使用 P=15的编带.
 ※1)公差请参照每个系列的尺寸图.
 ※2) $\phi 8 \times 5L$ (高度)最大值是6.5mm.